

Heavy-duty 330mm gravity fed 4 speed automatic safety slicer with removable knife



- **Operator safety is Number 1** combined with, durability, sanitation and performance
- **New EASY-LIFT mechanism** to raise & lower machine for cleaning underneath
- **330mm stainless steel CLEAN CUT™ 100% REMOVABLE KNIFE** for ease of cleaning and maximum hygiene
- Variable 4 speed automatic carriage & **3 stroke lengths**
- **Gauge plate (slice thickness) interlock** - gauge plate must be closed to remove carriage
- **No volt release** - if power fails or plug is removed slicer must be switched on again to re-start
- **Carriage system interlock** - gauge plate indicator must be closed to open or remove
- **Carriage system** can be **tilted open or removed** for cleaning
- **“Home” position to start**—for operator safety carriage must be in home position to start machine
- **Borazon stone long life sharpening attachment**
- Sanitary & heavy-duty **stainless steel** gauge plate, carriage face plate and knife cover
- Sanitary anodized aluminium base
- Permanently mounted **knife ring guard** - maximum safety when cleaning
- Low fence as standard
- Optional accessory - food chute

Technical Data

Knife size	330mm (stainless steel)
Speeds	Variable 4 speed automatic
Strokes lengths	3 different
Maximum cut	25mm thick
Carriage capacity	305mm wide / 190mm diameter
Safety	Knife ring guard
Removable Knife	Gauge plate interlock
Easy lift for cleaning under machine	Carriage interlock
	"Home" position to start
	No volt release
Drive mechanism	Heavy-duty poly V-belt
Motor size	0.37kW
Power supply	240/50/1 - 10amp
Power cord	Plug & cord - single phase
Shipping weight	67kg

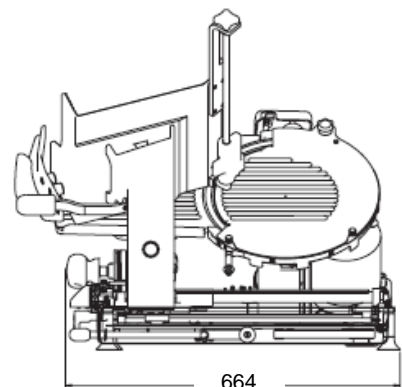
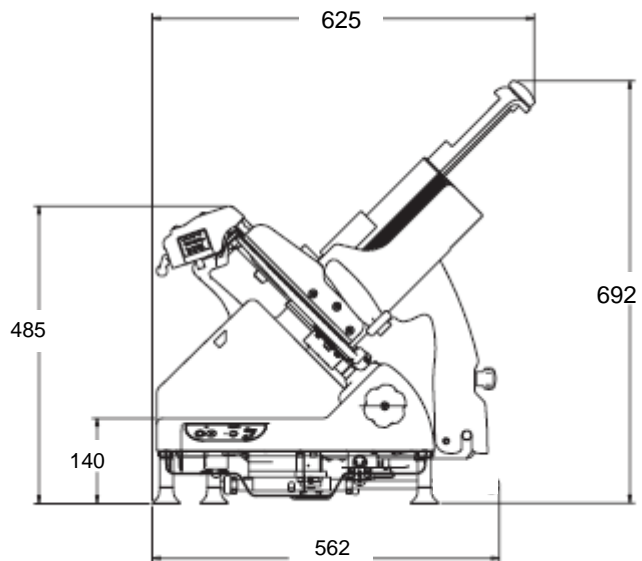
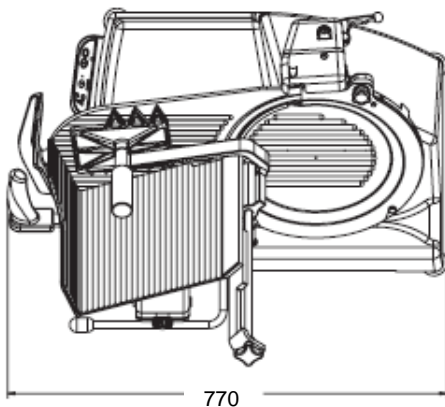

WARNING: ELECTRICAL AND GROUNDING CONNECTIONS MUST COMPLY WITH THE APPLICABLE PORTIONS OF THE NATIONAL ELECTRICAL CODE AND/OR OTHER LOCAL ELECTRICAL CODES IN FORCE.